

Royal Air Force Marham & King's Lynn & District Motor Club
Richard Burns Memorial Rally

Sponsored by Hylton Gott Subaru

14th & 15th August 2010

Competitor Bulletin No 2 Issued 09:00 6th August 2010

Many thanks for your entry – your start number is on the entry list on the website
A hard copy will be included in your competitors pack at signing-on.

DO NOT FORGET TO BRING YOUR VEHICLE PASSES AND PHOTO ID

This Competitor Bulletin No 2 is being sent to you printed in Black & White to save money. If you want it in colour it is available on the website in Full Colour as well as all the maps as individual pages.

1 GENERAL INFORMATION

- a) Gates will be open from 12:30 on Friday, please do not arrive before them as we have much work to do readying the venue for your arrival. Sound Test & Scrutineering do not open until 16:00 .
- b) Please follow the route shown to RAF Marham shown on the attached map. Enter via Crash Gate 5 and turn immediately left and follow route which will be arrowed, please bring only one service vehicle per competing car into the service area to minimise congestion, trailers should be left in the designated trailer park area.
- c) On unloading your car, proceed to Noise Check and Scrutineering. **DO NOT FORGET** to affix numbers to the **FRONT DOORS** of your car (numbers are on sale at Signing-On). Late numbers in the queue for Scrutineering **MUST**, if instructed by an Official, make way for early numbers. Early numbers are nevertheless instructed to arrive early and must not assume they will be allowed to queue-jump should they arrive late.

2 SERVICES and FACILITIES

- a) Catering: Monarch Catering of Bungay
- b) Tyres: Slicks Tyres Tel. 0114 247 0485 / www.slickstyres.co.uk
Please note that **NO FUEL** and limited **WATER** will be available on site – please bring with you any supplies that you will require during the day. Fuel should be sufficient for 110 stage miles.

3 SCRUTINEERING / SOUND TEST

- a) Sound Test & Scrutineering Friday 13th August 16:00 - 20:00
Sound Test & Scrutineering Saturday 14th August 07:00 - 09:30
- b) **NOISE:** Ensure that your car meets the MSA regulations of 100 dB(A) (see SR9). You will not be allowed to start if it fails the initial noise test or any subsequent checks made throughout the day.

4 SIGNING-ON

- a) Signing-On Friday 13th August 16:15 - 20:15
 Saturday 14th August 07:15 - 09:45
- b) We ask all competitors to arrive at Signing-On **FULLY PREPARED WITH ALL PAPERWORK**; items will be checked in the order shown on your process sheet. Please ensure that you arrive in plenty of time.
- c) You **MUST** be signed-on at least 30 minutes before your due start time.

5 COMPETITION NUMBERS:

A limited supply of numbers will be on sale at signing-on, cost 50p each.

www.richardburnsmemorialrally.co.uk



6 ADMISSION

You will find enclosed 3 vehicle passes for your use (Competing Car, Service Vehicle and Ancillary), see SR12(f)), please do not forget these as they will be required to enter the venue. Competitors who have indicated a requirement for camping will receive a camping vehicle passe in addition. Please be aware that you will be required to stay within the Service & Spectator area for the duration of the weekend (not including crews competing on a stage), see SR12(a). This area will be patrolled by Military Police and anyone found breaking this rule will be penalised accordingly. The Vehicle with the "Ancillary" pass will have to park in the overspill car park.

7 PENALTY MARKERS

Competitors are reminded of SR24. Penalty markers will consist of barrels, cones and other suitable media and penalties will be fairly applied from written reports from Judges of Fact. We are sure that neither you the Competitor nor we the Organisers want the event to be delayed while the artificial scenery is either repaired or replaced. It is for this reason that the penalties are applied. Competitors are also reminded of SR12(b) and SR12(c) the requirement to follow the route as defined on the stage maps and course markers. There is extensive airfield equipment remaining in-situ (lighting, signage etc) which may be concealed by stage equipment and will be required to function immediately after the event. To minimise the possibility of damage to this equipment anyone violating these regulations will be penalised accordingly.

8 OVERNIGHT PARKING & ACCESS

A campsite (with shower & toilet facilities) adjacent to the service area will be available to competitors, service crew & marshals on Friday & Saturday nights. The gates to the venue will be locked overnight between 22:00 (23:00 on Saturday) and 07:00

9 DRIVING STANDARDS

You are reminded of the 10 mph speed limit that is in force on all roads on RAF Marham (other than live Special Stages) and that the Road Traffic Act also applies (including alcohol limits). Military Police will be present throughout the whole event.

10 PACE NOTES

Competitor are reminded that Pace Notes are not permitted on Multi Use Stage Events. Ensure you are fully aware of the regulations and penalties for the possession of such notes. R24.7.5, R29.1.7 and R41.4.3. Checks will be made on the event and anyone in possession of such notes will be reported the MSA.

11 RETIREMENTS & PRACTICE RALLY:

If you miss any time controls on the event you will be retired as per the General Regulations of the MSA. You will not be permitted to start any of the following stages unless you qualify for the Practice Rally (see SR27 & the following):

If you retire from the main event on stages 1-4 you may join the Practice Rally on Sunday. You must inform Competitor Liaison in Rally HQ before 08:30, 15th August 2010 so that you may be included in the event. Once you have completed scrutineering you will be issued with your Timecard for Stage 5.

12 FRIDAY NIGHT ENTERTAINMENT

There will be a BBQ and Bar in Rally HQ on the Friday Evening starting at 19:00.

13 PARTY ON THE PAN

Tickets will be issued to the competing crews as part of their competitors packs at signing-on (2 free). A limited number of additional tickets will be available for purchase from the Helpdesk in Rally HQ at the same time for £10 each (cash only), which includes 1 free drink & food item and a live band. Please purchase additional tickets as early as possible to avoid disappointment.

14 AUCTION

At the Party on the Pan we will be having an Auction to raise additional money for the Charities. If you have any items you can donate to the auction please either contact Chris Daykin on 07779 239182 or bring them along with you.

15 OFFICIAL EVENT T-SHIRTS

These are available for pre-order from the event web site (www.richardburnsmemorialrally.co.uk); all pre-ordered shirts must be paid for in cash & collected by midday Saturday from the Helpdesk in Rally HQ.

16 EMERGENCY CONTACTS:

Event Director:	Ken Paterson	07831 321307
Clerk of the Course:	Colin Shinkins	07702 541708
Entries Secretary:	Lynda Shinkins	07885 630718
Secretary of Meeting:	Gary Nicholls	07895 040441
RAF Liasion	Chris Daykin	07779 239182
Rally HQ:		07811 732296

AND FINALLY.....

If you have any queries or concerns, please contact an Official who will be only too pleased to assist.

If you have any query over LICENCES contact the Clerk of the Course PRIOR to Friday.

We hope you have an enjoyable weekend's sport.

Royal Air Force Marham & King's Lynn & District Motor Club *Richard Burns Memorial Rally*

Sponsored by Hylton Gott Subaru

14th & 15th August 2010

How to get to RAF Marham

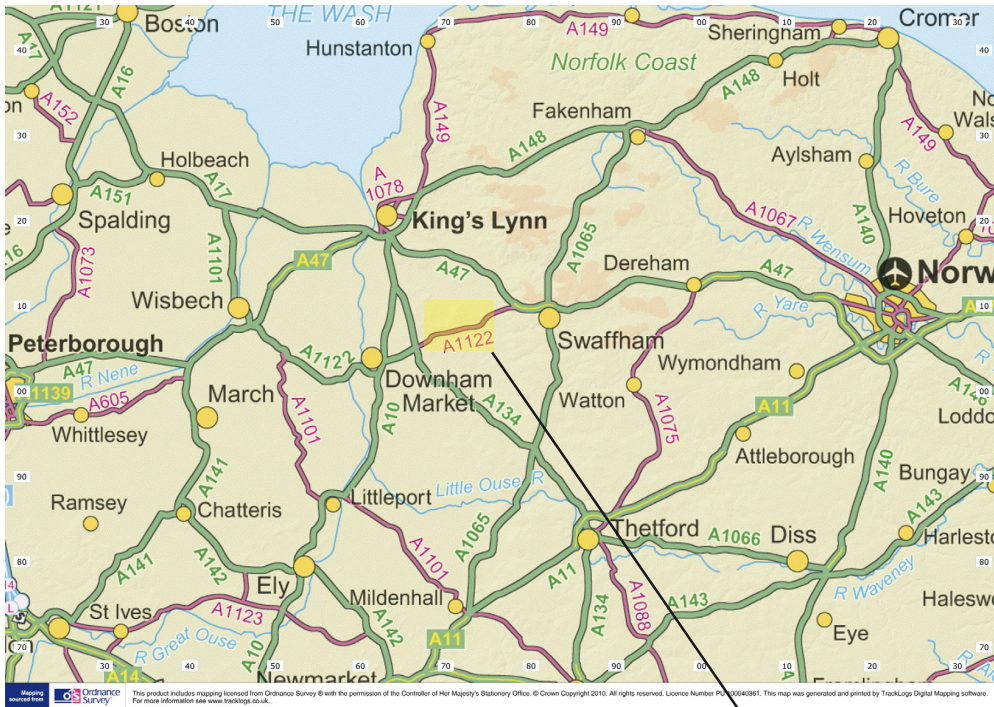

RAF Marham is located about 6 miles West of Swaffham, just off the A1122 Downham Market to Swaffham Road.

Please **only** approach the venue from the A1122, this is part of a Traffic Management plan to ensure we do not bring congestion and disturbance to Local Residents.

From the A1122 take **Chalk Lane** to the North, signposted **Narborough**. The entrance to the venue is approx 400 yards after leaving the A1122.

Approach routes will be signed.

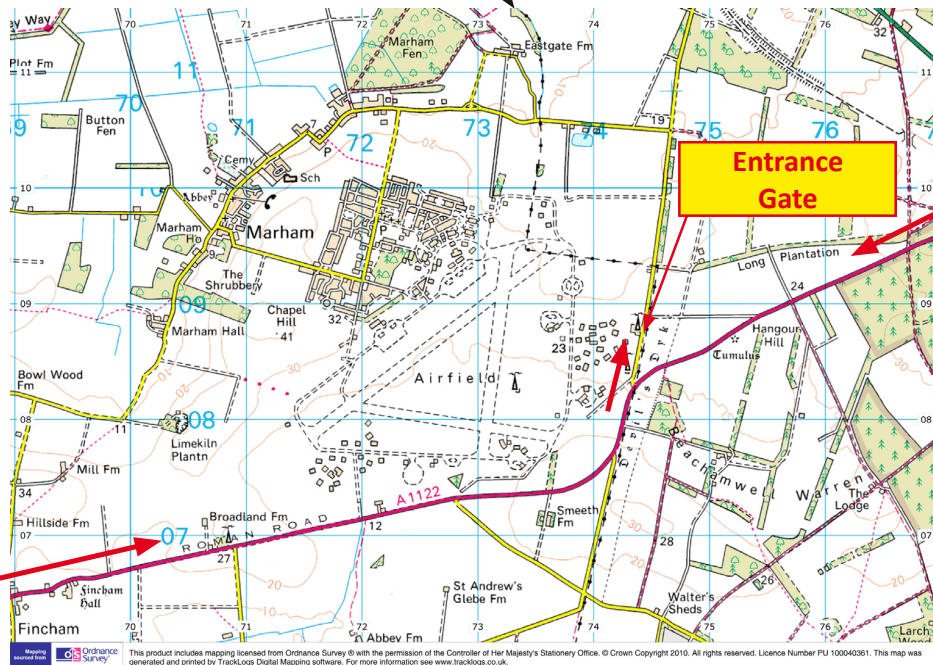

www.richardburnsmemorialrally.co.uk



Royal Air Force Marham & King's Lynn & District Motor Club

Richard Burns Memorial Rally

13th to 15th August 2010

Sponsored by Hylton Gott Subaru

General Site Plan

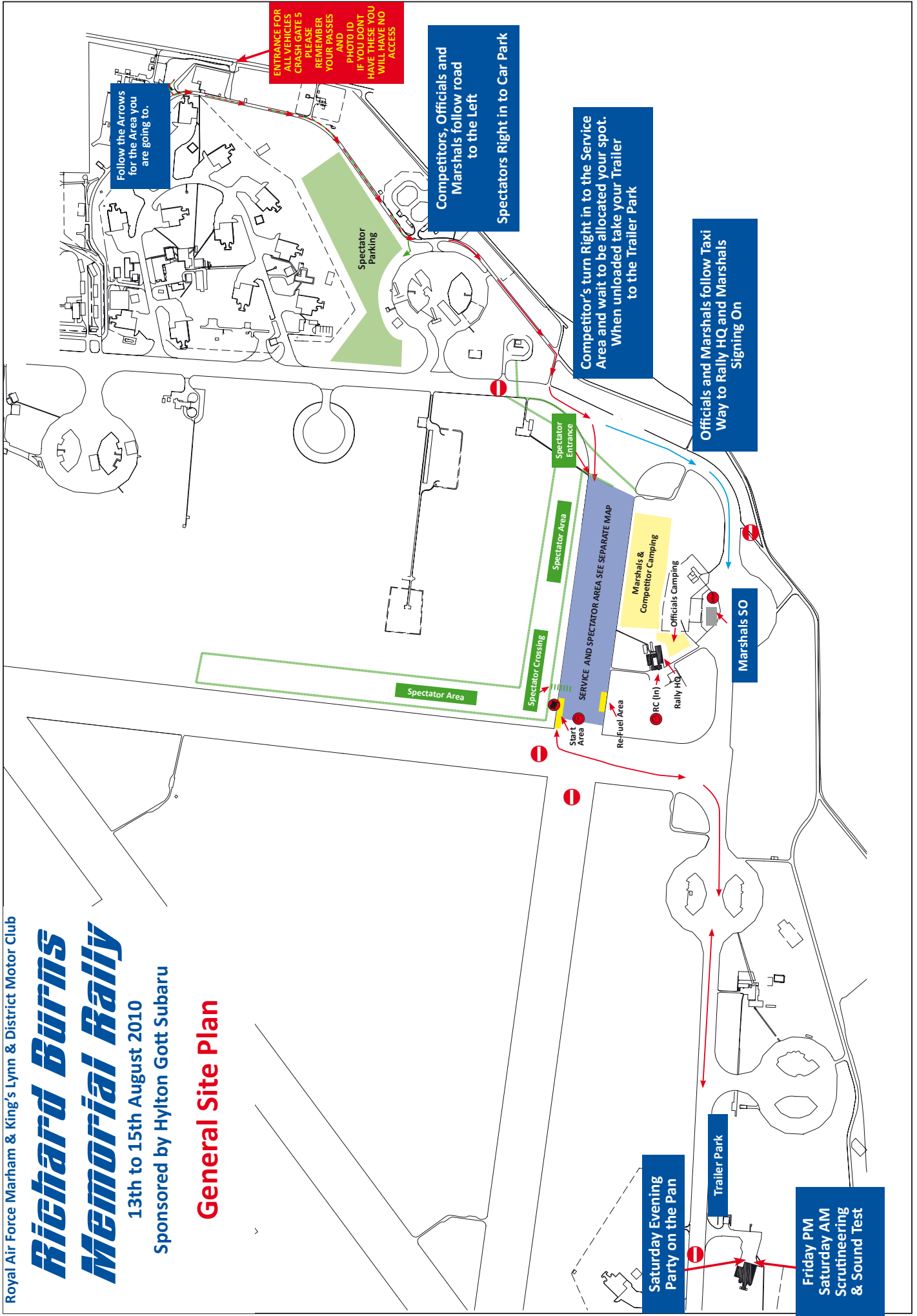

Royal Air Force Marham & King's Lynn & District Motor Club

Richard Burns Memorial Rally

13th to 15th August 2010

Sponsored by Hylton Gott Subaru

Service & Spectator Areas

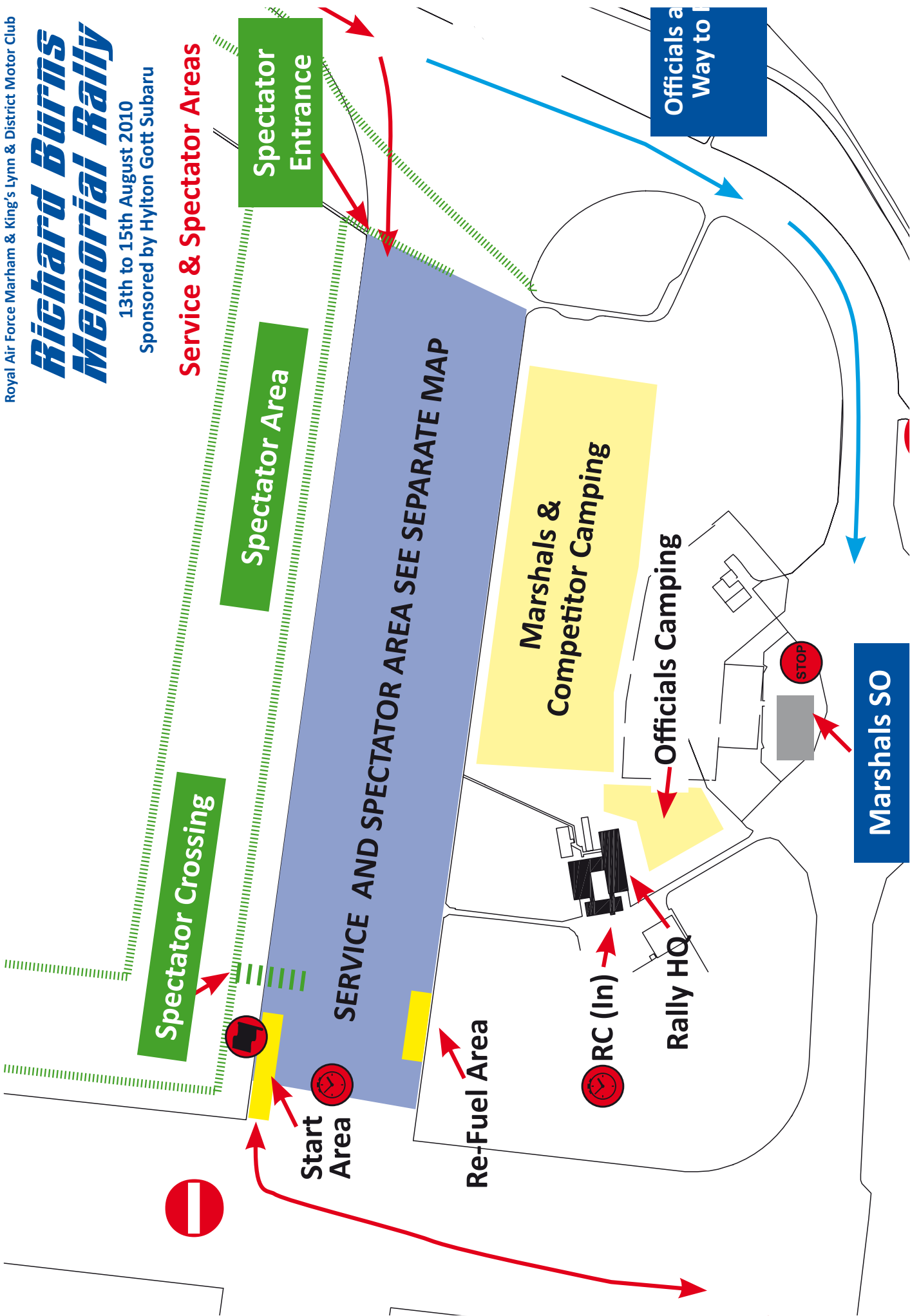

Royal Air Force Marham & King's Lynn & District Motor Club

Richard Burns Memorial Rally

13th to 15th August 2010

Sponsored by Hylton Gott Subaru

Service & Spectator Areas

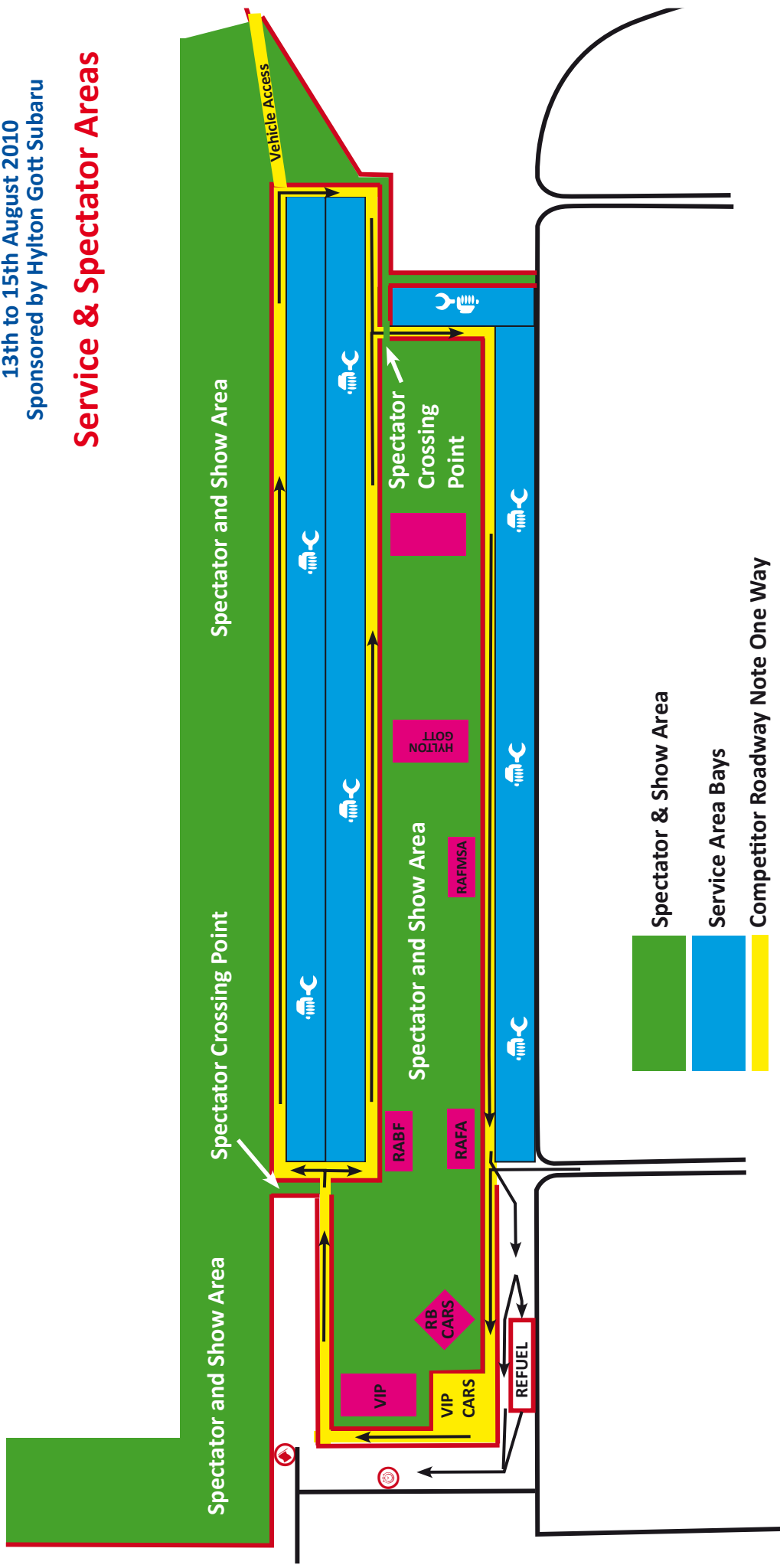

MSA Service Area Guidelines

Entrants, competitors and service crew members should be aware of their own and other people's safety and well being, when competing in motor sport.

1. All competitors should have an environmental ground-sheet in place before work commences on the vehicle.
2. All service vehicles should have an environmental spill-kit, for use in the event of liquid spillage. (Competing cars should also carry such a kit.)
3. Fire extinguishers should be readily available at all times when vehicles are to be worked on, particularly in the event of any welding or grinding being carried out and when vehicles are being refuelled.
4. Vehicles should be supported by axle stands, chassis sill stands or ramps, all with recommended base plates, when raised in the air by trolley or any other types of jack. Engines should not be run when the vehicle is raised on stands. No other work on the car should be attempted, when raising or lowering of the car is taking place.
5. If re-fuelling is permitted in the Service Area, this should be the last operation to be carried out before the vehicles leave. The vehicle should be off any support stands, have all four wheels on the ground, have all other work ceased and have no occupants, when re-fuelling commences. Ideally re-fuelling should be by hand pumping, rather than from hand held containers.
6. Spillage of any liquid should be contained immediately by the crew concerned.

A) Storage & Use of Petroleum Spirit

1. Containers should comply with the relevant British Standard, should be marked "Petroleum Spirit-Highly Flammable" and be kept from any source of ignition.
2. All empty containers should be removed from the venue after the event.
3. Petrol is to be used as fuel only, not for any other purpose.
4. All vehicle re-fuelling is to take place in the open air. A "No Smoking" area should be enforced and an operative should be on standby with a fire extinguisher.
5. Refuelling operatives, including those standing by with fire extinguishers, should ensure they are wearing protective clothing, including gloves and eye protection.

B) Hazardous Substances

1. Some vehicle parts, for example brake & clutch linings, contain asbestos. Competitors are encouraged to use non-asbestos substitutes where possible. Where asbestos is used, every effort should be made to prevent dust being released.
2. Some mineral oils may cause skin cancers. Where contact does occur, contamination should be washed off immediately. The wearing of any contaminated clothing should be avoided.
3. Other substances may cause ill health. Suppliers will have information about the possible effects of their products, on request.

C) Electrical Safety

1. All electrical equipment should be maintained in a safe condition.
2. Extension leads & cables should be neoprene, oil resistant flexible cable.
3. All electrical equipment used externally should be weatherproof and tools should be "double" or "all insulated" against electric shock.
4. Electrical equipment and hand tools should not be used where flammable vapours are present.

D) Fire Precautions

1. All competition and service vehicles should carry a suitable fire extinguisher.
2. Special consideration should be made before lighting any cooking appliance.
3. All sources of ignition should be kept away from any fuel store or re-fuelling area.
4. Fire extinguishers should not be moved from their known location, other than when in use.
5. In the event of any fire, a report should be made to the organisers of the event before leaving the venue.
6. All competitors are encouraged to train their personnel in correct fire prevention and treatment procedures.

E) Compressed Air Equipment

1. Air blasts from over inflated tyres can cause severe injury. Tyres should not be inflated above manufacturer's recommendation figures.
2. Always stand clear when inflating tyres.
3. Compressors & air lines should be inspected regularly.
4. Compressed air cylinders should be stored and used to supplier's recommendations.

F) General Working Practices

1. All working areas should be kept clean & tidy. All waste & spillage should be cleared up immediately, removed by the competitor at the end of the event and disposed of in a responsible manner.
2. Trailing cables & hoses should not be allowed to create a trip hazard and should not be run across access or roadways.
3. Whenever vehicle engines are being run, adequate ventilation must be in place.
4. All safety notices should be complied with.
5. Any personnel carrying out work should ensure that they adopt safe working practices at all times.
6. Service crews and competitors need to be aware of the long periods of exposure to cold, wet or heat, experienced while on location in service areas and dress accordingly.
7. Children under 16 years of age are to be closely supervised and should not leave your designated area unaccompanied.

They are children and as such are your responsibility!!

G) Noise

1. Exposure to excessive noise may result in hearing loss, or other complaints. These may be short term, or after prolonged exposure, permanent.
2. Where exposure to noise is unavoidable, ear defenders should be worn.

H) Manual Handling

1. Lifting, carrying and propelling of loads by bodily force is a major cause of industrial injuries. All competitors are encouraged to train their personnel in safe manual handling techniques.

I) Waste

1. Competitors should remove all waste from the venue, including containers, packaging, tyres, oils etc. They must be disposed of in a responsible manner.

J) Vehicle Safety

1. A 10 mph speed limit should be observed at all times in a Service Area, other than for Emergency Vehicles which may be attending an incident.
2. There may be pedestrians in Service Areas. Special care must be taken in these circumstances, to avoid collisions.
3. The unauthorised use of mopeds, motorcycles, scooters, go-peds, quads etc. is forbidden in Service Areas.
4. Vehicles may only be driven by persons holding valid driving licences for that class of vehicle.

K) First Aid

1. Any person sustaining injury or illness, should seek treatment from the event emergency services, by initially reporting to the Senior Official in charge of the Service Area, who will ensure the appropriate response.

L) Public Safety

1. Competitors and their associated personnel should act in a manner so as not to put either themselves or any other person at risk of injury.

M) Reporting of Accidents & Incidents

1. All accidents where any person sustains injury, or where damage to property occurs, should be reported immediately to the Senior Official in charge of the Service Area.

N) Further Regulations and Information

1. Competitors are reminded of their obligations to comply with the requirements of the appropriate sporting regulations at all times. These Guidance Notes should be read in conjunction with all relevant regulations.